



# Guide to Educator (Local) Scoring

## Educator Scoring



To Score Student Data, choose the “Educator Scoring” application.

The screenshot shows the LAS Links application interface. At the top, there are logos for DRC INSIGHT, LAS LINKS, and MY APPLICATIONS. Below these are three main sections: PARTICIPANT PREPARATION, SCORING AND REPORTING, and OTHER LINKS. The 'Educator Scoring' option is highlighted with a red box. A red arrow points to the 'MY APPLICATIONS' dropdown menu.

PARTICIPANT PREPARATION	SCORING AND REPORTING	OTHER LINKS
Student Management	<b>Educator Scoring</b>	Professional Learning
Student Group Management	Report Delivery	License Dashboard
Test Administrator Management	Interactive Reports	
User Management	GENERAL INFORMATION	
TEST PREPARATION	General Information	
Test Management	TECHNOLOGY SETUP	
POST-TEST ACTIONS	Central Office Services	
Student Management		

# Educator Scoring



**Scoring**

Instructions

\* Indicates required fields

Administration: LAS Links  
District: Sales and Training District -  
School: Gina Davis Sales and Trainin

LAS Links Form: English Form A  
Assessment: (All)  
Session:

Session Detail

Session Name	Assessment	Session Status	Begin Date	End Date	Item Counts	Action
--------------	------------	----------------	------------	----------	-------------	--------

Choose from the above filters and click on 'Show Sessions' to view matching 'Sessions'

- Choose the form you need to score
- Filter by grade span by clicking on the Assessment dropdown
- Filter by session by typing in the session name in the Session search field

3

# Educator Scoring



**Scoring**

Instructions

\* Indicates required fields

Administration: LAS Links  
District: Sales and Training District -  
School: Gina Davis Sales and Trainin

LAS Links Form: Espanol A  
Assessment: (All)  
Session:

Show Sessions

Session Detail

District	School	Session Name	Assessment	Session Status	Begin Date	End Date	Item Counts	Action
Sales and Training District	Gina Davis Sales and Training School	GDAVIS ESPANOL ALL SUBTESTS	Grades 2-3 (Esp. A)	Completed	11/8/2017	12/31/2024	0 available, 0 in process, 20 complete	
Sales and Training District	Gina Davis Sales and Training School	GDAVIS TEST GR 2-3	Grades 2-3 (Esp. A)	In Progress	10/11/2017	12/31/2024	20 available, 0 in process, 0 complete	

Click the Show Sessions button

Item Counts:

- Available = items that need to be scored
- In Process = items that have been scored and are processing through the scoring system
- Complete = items that processed correctly through the scoring system and are moving towards reporting

4

# Educator Scoring



## Scoring

**Instructions**

\* Indicates required fields

Administration: LAS Links \*  
 District: Sales and Training District \*  
 School: Gina Davis Sales and Training

LAS Links Form: Espanol A \*  
 Assessment: (All)  
 Session: [ ]

**Show Sessions**

Session Detail							
District	School	Session Name	Assessment	Session Status	Begin Date	End Date	Item Counts
Sales and Training District	Gina Davis Sales and Training School	GDAVIS ESPANOL ALL SUBTESTS	Grades 2-3 (Esp. A)	Completed	11/8/2017	12/31/2024	0 available, 0 in process, 20 complete
Sales and Training District	Gina Davis Sales and Training School	GDAVIS TEST GR 2-3	Grades 2-3 (Esp. A)	In Progress	10/11/2017	12/31/2024	20 available, 0 in process, 0 complete

Score by Student

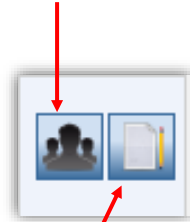

Score by Session

5

# Educator Scoring



## Scoring Status

**Instructions**

Last Name: [ ]

**Filter Clear Refresh**

Scoring Status - English Form A (Grades 2-3 (Eng. A))						
Last Name	First Name	Grade	Student ID	Content Area	Item Counts	Action
MCGUIRE	ALISON	03	1990	READING		[Score Student]
MCGUIRE	ALISON	03	1990	SPEAKING	17 available, 2 in process, 1 complete	[Score Session]
MCGUIRE	ALISON	03	1990	WRITING	5 available, 0 in process, 0 complete	[Score Session]

Educator Scoring ELL030

01A Speaking Gr 01 Q857465  
 Project: ELL030  
 Lithocode: 990004805554

Question: 01A Speaking Gr 01 Q857465

0:00 / 0:03 [Progress Bar]

Score 0 / 1

<< Prev Current Next >>

<< Prev Scoring Resource Next Scoring Resource >>

Response [ ] Scoring Resources [ ]

Scoring Resources Filter: Rubric

**Submit**

**Exit Scoring**

### Score by Student:

- Choose from the roster of students and content areas that have items available for scoring
- Click the “Score Student” icon in the Action column

### Score by Session:

- Puts you right into the scoring page
- Score without knowing who the student is
- Score the same item over and over until all like items in that session are scored
- Automatically takes you to the next batch of like items

6

# Educator Scoring

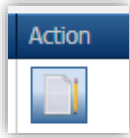

**IMPORTANT:**  
Be sure to enable popups from [scoring.drctdirect.com](http://scoring.drctdirect.com) so that you are able to complete scoring

When you clicked on the Action button (as shown in the previous slide) a new page will pop up taking you to a new URL.

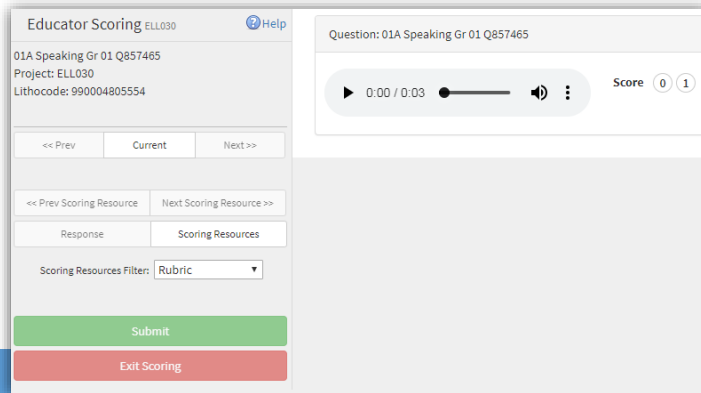

7

# Educator Scoring



For this item, we are on: Item #1, Form A, Speaking, Grade 01  
If scoring *Español* forms, "Speaking" will read as "Hablando"

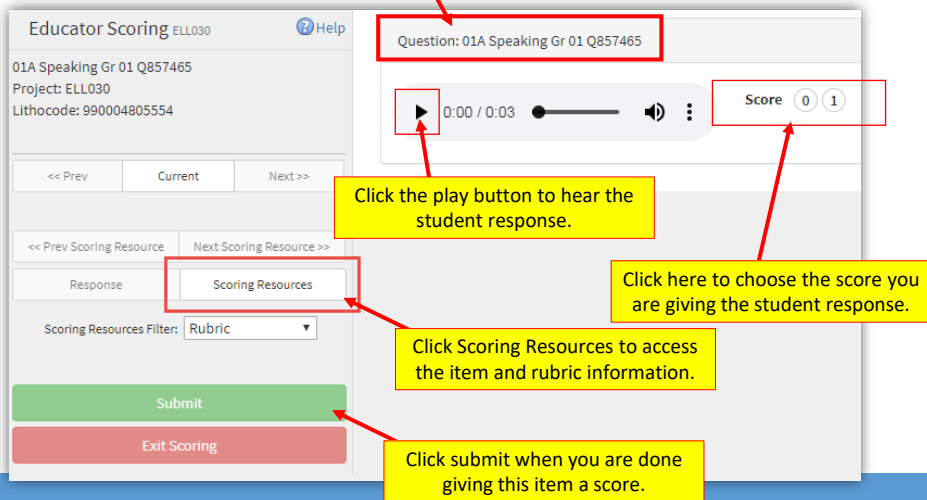

8

# Educator Scoring

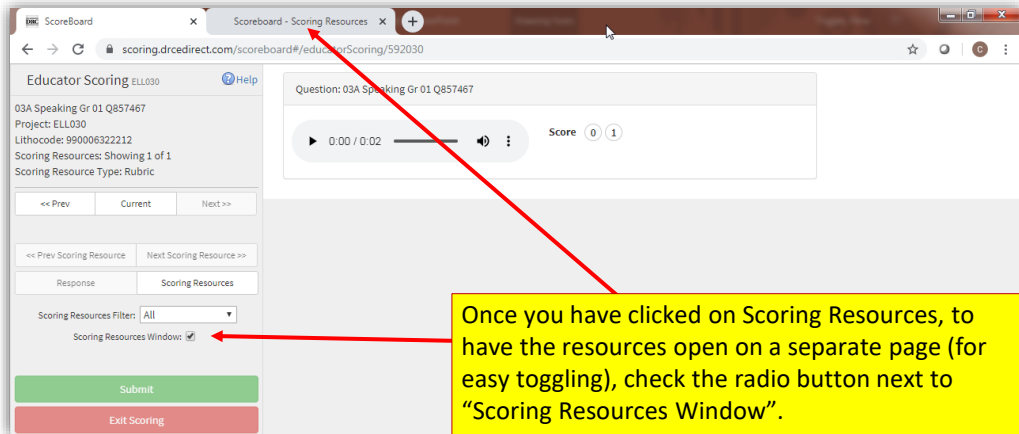

Once you have clicked on Scoring Resources, to have the resources open on a separate page (for easy toggling), check the radio button next to "Scoring Resources Window".

Scoring resources include the item presented to the student, the rubric and exemplars.

9

# Educator Scoring

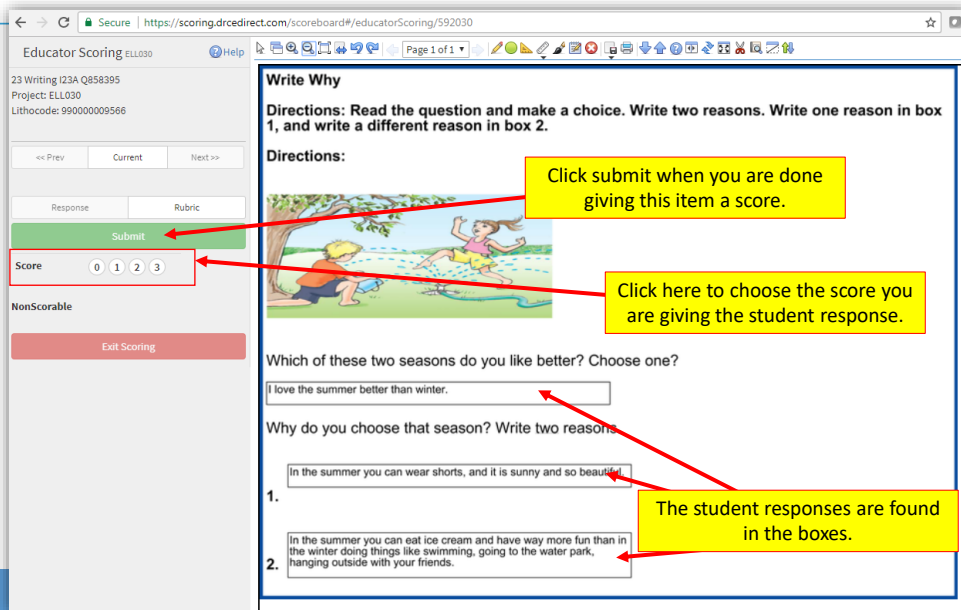

Click submit when you are done giving this item a score.

Click here to choose the score you are giving the student response.

The student responses are found in the boxes.

10



## DRC Customer Service – Texas

Toll Free: 833-867-5679 Option 1

**Order Support**

Texas Order Support Email:

[LASOrderTX@datarecognitioncorp.com](mailto:LASOrderTX@datarecognitioncorp.com)

Toll Free: 833-867-5679 Option 2

**Technical Support**

Texas Technical Support Email:

[LASTechTX@datarecognitioncorp.com](mailto:LASTechTX@datarecognitioncorp.com)

Customer Service Hours: 8:00 am – 4:30pm CT M-F

[www.LASLinks.com/Texas](http://www.LASLinks.com/Texas)